

FLOW VIEW™ MODULAR BALL FLOW INDICATORS

Cost effective, modular, flexible configuration ball flow indicators let you see the liquid flow when you can't see the nozzles or outlets

For additional information see publication no. 10205-01



FLOW VIEW MODULAR FLOW INDICATOR ASSEMBLIES

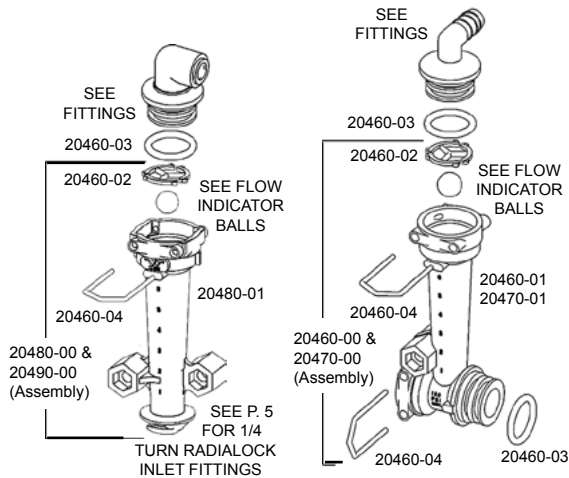

Isolated Feed Ball Flow Indicators (20480-00 & 20490-00) can be used with metering / positive displacement / squeeze pumps where individual line monitoring is required.

Manifold Ball Flow Indicators (20460-00 & 20470-00) are modular and can be assembled into a manifold to feed / monitor multiple lines from a single feed line.

FLOW INDICATOR ASSEMBLIES

MANIFOLD - Includes Body, Ball Retainer, O-Ring, 2 U-clips and green, red, maroon glass, & 1/2" SS balls

20460-00	STANDARD FLOW with BUNA-N O-RING	
20460-V0	STANDARD FLOW with VITON O-RING	
20470-00	LOW FLOW with BUNA-N O-RING	
20470-V0	LOW FLOW with VITON O-RING	

ISOLATED FEED - Includes Body, Ball Retainer, 1 U-clip and green, red, maroon glass, & 1/2" SS balls

20480-00	STANDARD FLOW	
20490-00	LOW FLOW	

FLOW INDICATOR COMPONENTS

20460-01	FLOW INDICATOR BODY - MANIFOLD - STANDARD FLOW	
20470-01	FLOW INDICATOR BODY - MANIFOLD - LOW FLOW	
20480-01	FLOW INDICATOR BODY - ISOLATED FEED - STANDARD FLOW	
20490-01	FLOW INDICATOR BODY - ISOLATED FEED - LOW FLOW	
20460-02	BALL RETAINER	
20460-04	LOCK U-CLIP, 302SS	
20460-03	O-RING #212 - BUNA-N (For Indicator Body and Fittings)	
20460-15	O-RING #212 - VITON (For Indicator Body and Fittings)	
40225-04	O-RING #015 - BUNA-N (For Ori ice Inserts)	
40225-05	O-RING #015 VITON (For Ori ice Inserts)	

Example of a Standard or Low Flow Isolated Feed model assembly

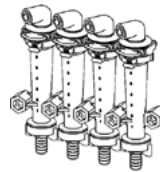

Example of a Standard or Low Flow Manifold model assembly

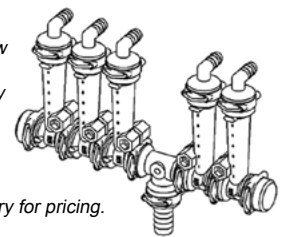

Flow Indicator assemblies are available. Please consult factory for pricing.

FLOW VIEW O-RING SEAL (ORS) FITTING ASSEMBLIES - includes fitting, seal(s) and / or Locking U-clip

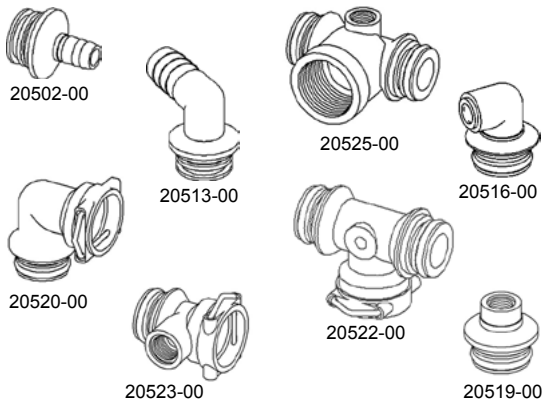

BUNA-N SEAL	VITON SEAL	O-RING SEAL (ORS) FITTING ASSEMBLIES - Includes fitting, seal(s) and Locking U-clip	BUNA-N SEAL	VITON SEAL
20501-00	20501-V0	ORS x HOSE SHANK-STRAIGHT - 3/8"		
20502-00	20502-V0	ORS x HOSE SHANK-STRAIGHT - 1/2"		
20503-00	20503-V0	ORS x HOSE SHANK-STRAIGHT - 3/4"		
20511-00	20511-V0	ORS x HOSE SHANK-90 DEGREE - 3/8"		
20512-00	20512-V0	ORS x HOSE SHANK-90 DEGREE - 1/2"		
20514-00	20514-V0	ORS x HOSE SHANK-90 DEGREE - 5/8"		
20513-00	20513-V0	ORS x HOSE SHANK-90 DEGREE - 3/4"		
20516-00	20516-V0	ORS MALE x 1/4" PUSH-IN TUBE - 90 DEGREE		
20517-00	20517-V0	ORS MALE x 3/8" PUSH-IN TUBE - 90 DEGREE		
20518-00	20518-V0	ORS MALE x 1/4" NPTF 90 DEGREE		
20519-00	20519-V0	ORS MALE x 1/4" NPTF		
20520-00	20520-V0	ORS MALE x ORS FEMALE-90 DEGREE		
20522-00	20522-V0	ORS MALE x ORS MALE x ORS FEMALE - TEE		
20523-00	20523-V0	ORS MALE x ORS FEMALE(BLIND) X 3/8" NPTF - ISOLATOR TEE		
20524-00	20524-V0	ORS MALE x ORS FEMALE X 3/8" NPTF - TEE		
20525-00	20525-V0	ORS MALE x ORS MALE X 1" NPT FE- TEE		
20526-00	20526-V0	ORS MALE x ORS MALE X ORS FEMALE - TEE with 1/4" NPTF PORT		

FLOW VIEW O-RING SEAL (ORS) END CAP ASSEMBLIES - includes fitting and Locking U-clip



O-RING SEAL (ORS) END CAP ASSEMBLIES - Includes fitting and Locking U-clip

20521-00	ORS CAP	
20535-00	FITTING ASSY - ORS FEMALE x 1/4" NPTF	
20536-00	FITTING ASSY - ORS FEMALE x 3/8" NPTF	
20537-00	FITTING ASSY - ORS FEMALE x 1/2" NPTF	

FLOW VIEW FLOW INDICATOR BALLS

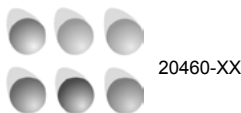

FLOW INDICATOR BALLS

		FLOW RATE - USGPM (water)	
		STANDARD	LOW FLOW
20460-13	BALL - FLOW INDICATOR-ORANGE POLYPROP	0.05-0.18	0.03-0.09
20460-08	BALL - FLOW INDICATOR-GREEN POLYPROP	0.05-0.18	0.03-0.09
20460-07	BALL - FLOW INDICATOR-RED CELCON	0.09-0.30	0.05-0.14
20460-06	BALL - FLOW INDICATOR- MAROON GLASS	0.31-0.72	0.10-0.18
20460-05	BALL - FLOW INDICATOR-1/2" STAINLESS STEEL 302	0.40-1.33	0.15-0.70
20460-10	BALL - FLOW INDICATOR-7/16" STAINLESS STEEL 302	1.00-2.70	N/A

FLOW VIEW CHECK VALVES and FLOW METERING ORIFICE PLATES



BUNA-N SEAL	VITON SEAL		BUNA-N SEAL	VITON SEAL
21000-00	21000-V0	ORIFICE INSERT ASSY - BLANK		
21XXX-00	21XXX-V0	ORIFICE INSERT ASSY - See note below for sizes		
24000-00	24000-V0	CHECK VALVE ASSY		
24XXX-00	24XXX-V0	ORIFICE INSERT ASSY WITH CHECK VALVE - See note below for sizes		

Metering orifices can be inserted in place of the Flow Indicator Ball Retainer and utilized to control flows ranging from 0.004 to 8.0 USGPM. Refer to the Flow Indicator section in the Downloads section of www.wilger.net for an orifice selection chart.